

HANDY SWEEP 600

Instructions for Use

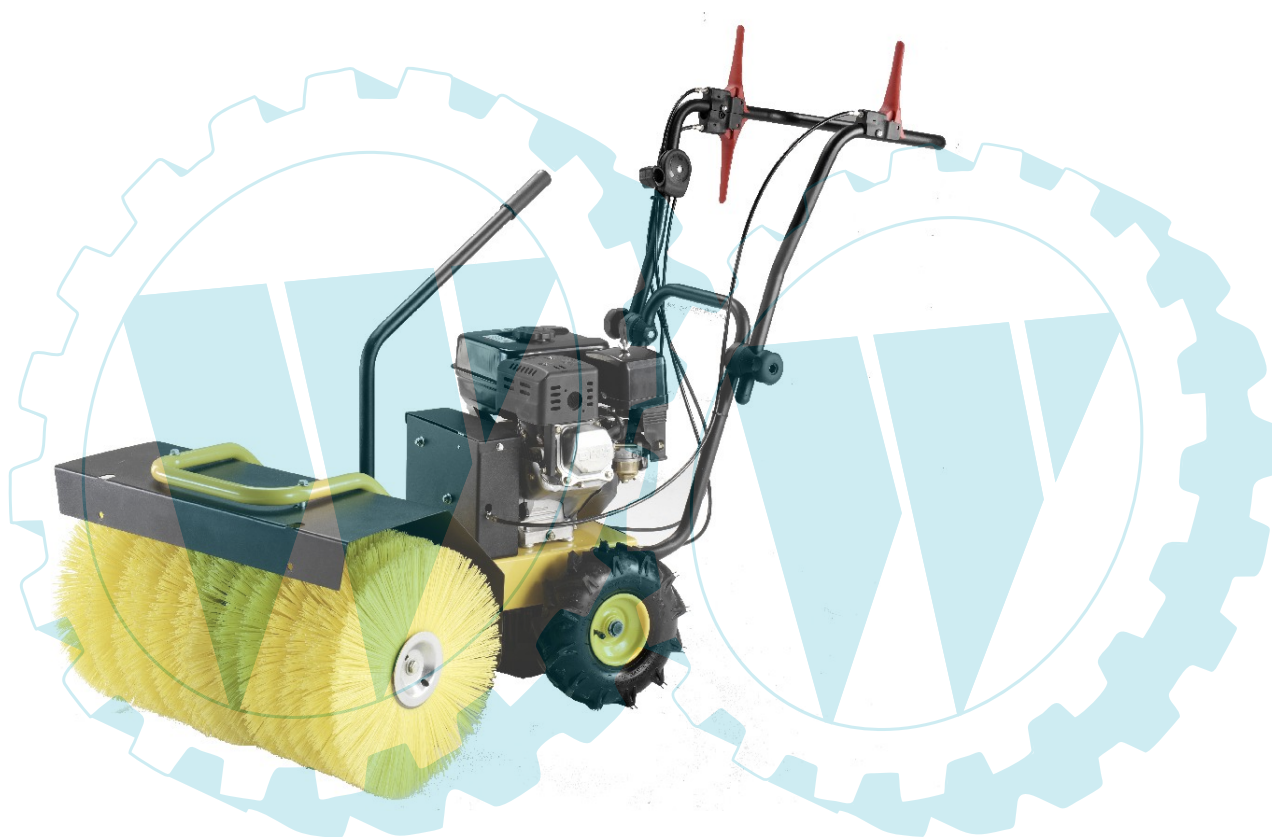

TEXAS ANDREAS PETERSEN A/S

Knullen 2 - Højby - 5260 Odense S - Denmark

Phone: +45 6395 5555 - Fax: +45 6395 5558

E-mail: post@texas.dk, www.texas.dk

Instruction No. 90700780

Congratulations on the purchase of your HANDY SWEEP. We are convinced that this machine will meet your needs. Please read this manual carefully before use. This may prevent possible damage to the machine. Please pay special attention to the safety instructions marked with this symbol:



List of Contents:

Page

Safety Procedures.....	3
Contents of the Box.....	3
Before Starting the Machine.....	4
Working with the HANDY SWEEP	5
- Starting the machine	
- Stopping the machine	
- Height adjustment of stabilising wheels	
- Swinging of brush	
Maintenance.....	6
Technical Specifications.....	6
EC declaration of conformity	7
Spare parts list www.texas.dk	



SAFETY PROCEDURES

You should ALWAYS read the instructions for use before you start the machine to obtain the highest possible safety.

The sweeper should ONLY be used by persons who understand and are able to follow all the safety procedures and instructions for use mentioned in this manual. Never let children operate the machine. Keep pets away from the machine, and make sure that the working area is free of big stones, pointed items etc.

NEVER run the motor in an enclosed room as the exhaust gas contains carbon monoxide, which can lead to uneasiness and in the worst case death.

NEVER fill the machine with fuel indoors, and remember that the motor shall be stopped. NEVER fill the machine with fuel, when it is hot, as there is a risk of ignition. Avoid open fire at the place where fuel is filled up, and wipe off any wasted fuel before you start the sweeper.

Wear appropriate clothes and footwear, e.g. working clothes or casual wear plus rubber boots. NEVER wear loose clothes when you use the sweeper. The sweeper's guard plate should NEVER be removed.

The rotating parts should NEVER be touched while the motor is running. NEVER make any adjustments with the motor running, and NEVER leave the sweeper with the motor running. ALWAYS remove the sparking plug cap before repair is being made.

ALWAYS check the bolts and nuts before use.

Maintain the sweeper according to the recommended procedure and use only ORIGINAL spare parts. If defects are seen, ALWAYS contact your authorised dealer or service workshop who can carry out the repair in the right way.

ALWAYS check the oil level of the motor before using the sweeper.

You should ALWAYS make sure that any person who uses the sweeper has read this manual carefully.

Only use the sweeper in areas where it can be used in a safe way. Avoid working with the sweeper in areas with steep slopes and ALWAYS keep both hands on the handlebar of the machine when you operate it.

Note that the machine is supplied without oil in the motor.

CONTENTS OF THE BOX:

Sweeper mounted.
Instructions for use

BEFORE STARTING THE MACHINE

Oil filling:

Place the motor in a horizontal position. Remove the oil plug and fill with oil right to the edge.

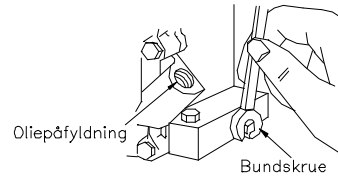

Oil type:

- X Please note: 10W-40 oil can be used if 10W-30 is not available.
- XX If this oil is not available, a synthetic oil with a viscosity of 5W-20, 5W-30 or 5W-40 can be used.

Only use high-quality oil, e.g. SC, SD, SE, SF and SG. The oil type used depends on the ambient temperature when the machine works.

Summer:

(Temperature above 10°C)
SAE 30 or SAE 10W-40

Winter:

(Temperature below 10°C)
SAE 20 or SAE 10W-30

Anbefalede olie kvaliteter

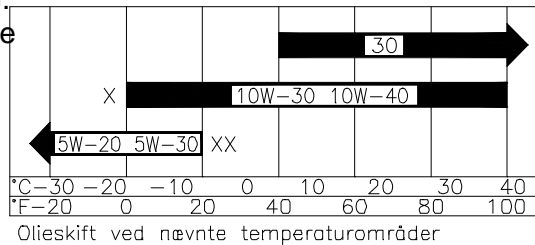

Fuel



Use lowest available octane unleaded fuel. When filling, place the machine in a horizontal position. **Always** replace old fuel. **Always** stop the motor when fuelling. **Never** fill up with fuel on a hot motor.

Never use gasoline mixed with oil.

Operation – start and stop

Cold motor:

Activate the motor choke.
Set the throttle control on full speed

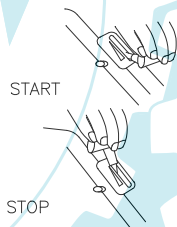

First, pull the starting rope a couple of times, shortly, until it feels tight. Pull the starting rope slowly to the point where it feels tight, place your left hand on the motor in order to hold back, and pull the starting rope hard once. When the motor runs, deactivate the choke.

PLEASE NOTE:

Never let the starting rope wind again by itself. Follow it all the way back with your hand. If the motor will not run in spite of several attempts this may be caused by the fact that there is too much fuel in the cylinder/carburettor, and that the sparking plug has become moist. Dismount the plug and wipe it off.

Stop the motor:



Set the throttle control in position "STOP". Set the throttle lever to idle and let the motor run idle for 10-20 seconds before the lever is moved to stop. **Never** leave the sweeper without stopping the motor. Do not turn off the motor by switching on the choke, as this may result in damage to the motor.

WORKING WITH THE HANDY SWEEP 600

The sweeper moves forward by quickly pushing down the right lever. Fig 1

The sweeper moves backwards by quickly pulling the right lever. Fig 2

The brushes are activated by quickly pushing down the left lever. Fig 3

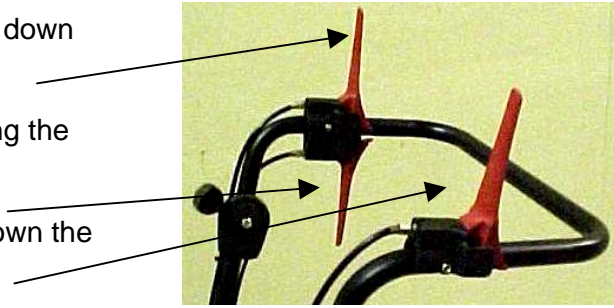

The sweeper is equipped with a dead man's handle, which means that when you release the levers, the brush and machine stop. In case of accidents you should release the levers as quick as possible and stop the engine.

Height adjustment of stabilising wheels and brushes:

Once the brushes get worn it is necessary to adjust the height of the brushes, i.e. how close they are to the surface to sweep. This adjustment takes place by moving the plastic rings of the brush stabilising wheels.

Dismount the stabilising wheels and remove **one** plastic ring from the bottom (illus. No. 1). Mount the wheel again (illus. No. 2). This lifts up the stabilising wheel and the brushes will come closer to the surface. Finally, mount the plastic ring, sleeve and locking ring (illus. No. 3).

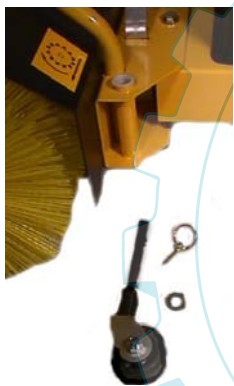

No. 1



No. 2



No. 3

Swinging the brush:

The brush can be swung 20 degrees to either side. Press the steering knuckle arm for the brush, turn the brush and let go of the handle, so that the catch will fall correctly into place.

(Illus. No. 4)



No. 4

Find information about the engine in the Motor manual instruction

TECHNICAL SPECIFICATIONS

Specifications for the sweeper:

Total machine width	78 cm
Working width	60 cm
Weight of the sweeper.....	58 kg
Brush diameter	30 cm

Accessories to come: Collection boxSnow blade

HUSK AT UDFYLDE

IMPORTANT

Udfyldes af forhandler / køber.

To be fill in by dealer/user.

Købsdato / buying date:

Produktionsår / production year:

Model / model:

Motornummer / engine number:

Motorproducent / engine manufacturer:

Stelnummer / chassis number:

Reservedele

Reservedelstegning over det pågældende produkt findes
på vores hjemmeside **www.texas.dk**

Finder du selv varenumre, giver det en hurtigere ekspedition.

For køb af reservedele, kontakt venligst din nærmeste forhandler.

Du finder forhandlerliste på Texas' hjemmeside.

Spare parts

Part list and explosive drawings for the specific product, can be found
on our website **www.texas.dk**

If you help find part numbers yourself, it will ease the service.

For purchase of spare parts, please contact your dealer.

Certificate of Conformity

Clause 8 of Directive 98/37/EC and Directive 2000/14/EC

Manufacturer: **TEXAS Andreas Petersen A/S**
Knullen 2, Højby
DK-5260 Odense S
DANMARK

Hereby declares that the following sweeper:

Machine type	Sweeper
Make	TEXAS
Motor type	Combustion engine
Model designation	Handy Sweep
Series identification	Handy Sweep

Complies with machinery directive 98/37EC and directive 200/14 EC on noise Emission from machines.

The machine also confirms to DS/EN 709

Odense den 1. December 2004

TEXAS Andreas Petersen A/S

Verner Hansen
Managing Director

